

Base Cabinet Rollout Drawer

Installation Instructions

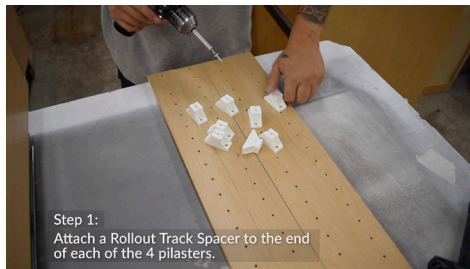

De Pere Cabinet, Inc.

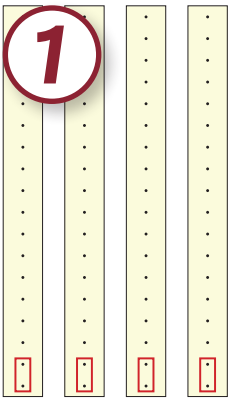

Step 1: Attach a Rollout Track Spacer to the end of each of the 4 pilasters.

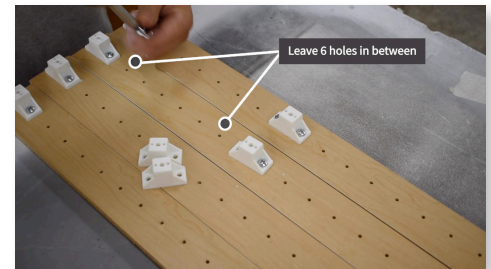
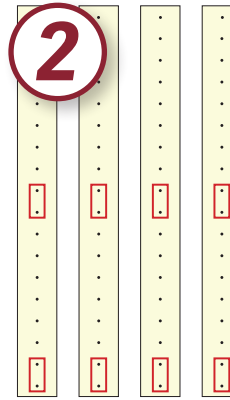

Step 2: Attach a second Rollout Track Spacer to each pilaster. For our standard rollout placement in a base cabinet leave 6 holes in between spacers.

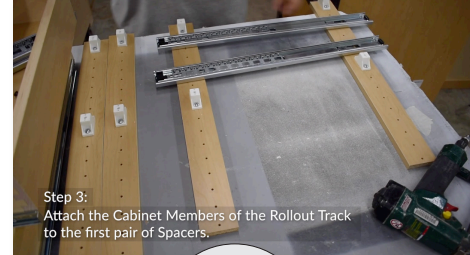

Step 3: Attach the Cabinet Members of the Rollout Track to the first pair of spacers.

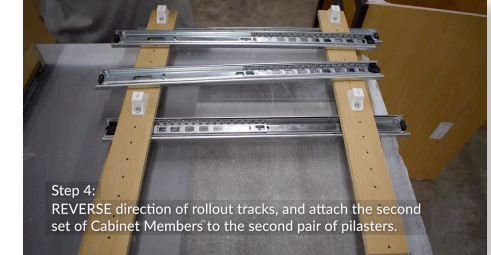
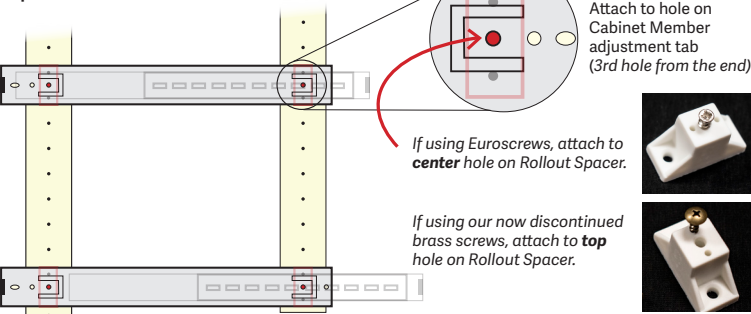

Step 4: REVERSE direction of Rollout Tracks, and attach the second set of Cabinet Members to the second pair of pilasters.

Step 5: Attach pilasters and Cabinet Members into the cabinet in the direction shown, lining up the front edge a 1/4" from back of face frame.



Step 6: Attach pilasters and Cabinet Members into the opposite side of cabinet, lining up the front edge a 1/4" from back of face frame.



Inside cabinet: Left view

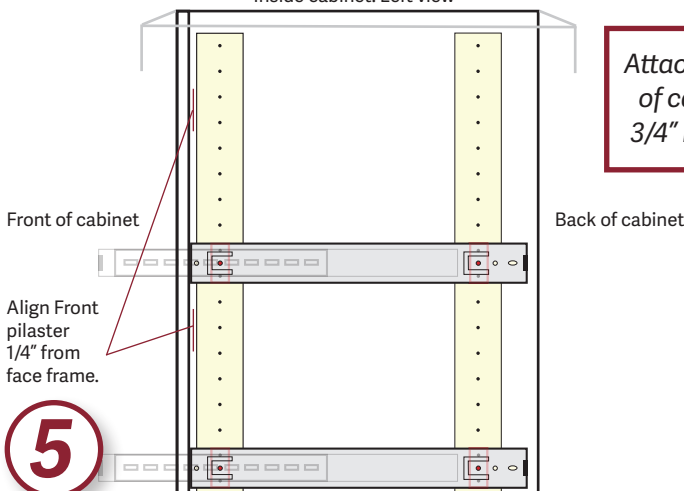

Attach pilasters to inside of cabinet using either 3/4" nails or 7/8" screws

Inside cabinet: Right view

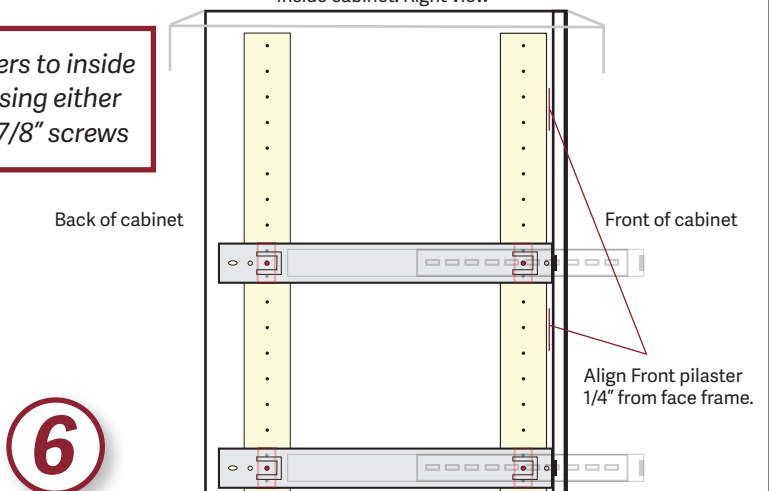

Base Cabinet Rollout Drawer

Installation Instructions

pg 2

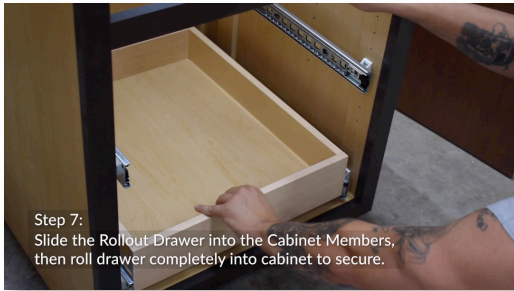

Step 7:
Slide the Rollout Drawer into the Cabinet Members,
then roll drawer completely into cabinet to secure.

7

Step 7: Slide the Rollout Drawer into the Cabinet Members, then roll drawer completely into cabinet to secure.

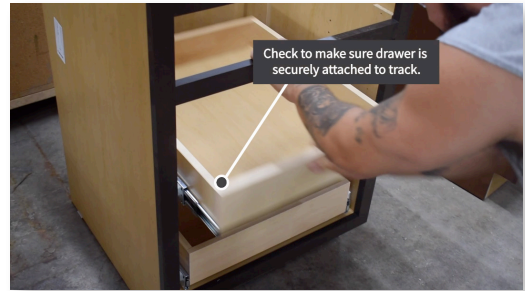

Check to make sure drawer is
securely attached to track.

8

Check to make sure drawer is securely attached to track.

Scan here to watch the video:

